

REQUEST FOR PUBLIC IMPROVEMENT
(To be used only for special assessment improvements)

Please use BLACK INK & PRINT ADDRESS

Petition Circulator: Jeanne M Williams
 Circulator Address: 301 N. Edison Ave
 Phone Number: 248 399 0628

PAGE 1 OF 2

To the Honorable,
 The Mayor and City Commission
 Royal Oak, Michigan

We, the undersigned, owners of property in the City of Royal Oak to be benefited by the proposed improvements, description of which property, and our addresses, are set forth opposite of respective names hereto, do hereby request the following public improvement, to wit:

SPECIAL ASSESSMENT 31' WIDE, 6" THICK CONCRETE PAVING WITH INTEGRAL CURB AND GUTTER OF N. EDISON AVENUE FROM E. UNIVERSITY TO THE N. LOT LINE OF LOT 46.

This request is not made for the purpose of initiating such improvement, but only for advising the City Commission of our desire for such improvement and willingness to have our property assessed therefore if the Commission, in the exercise of its discretion, order such improvement to be made.

Owner Name (Signature and Printed)	Address	Lot No.	Subdivision	Benefit Unit
<i>Jan Choike</i> Jan Choike <i>Jamie Veresh</i> Jamie Veresh	300 N EDISON (72-25-14-353-070)	LOT 79	BASSETT & SMITH'S FIRST STREET SUB	1
<i>Jeanne M Williams</i>	301 N EDISON (72-25-14-353-066)	LOT 46	BASSETT & SMITH'S FIRST STREET SUB	1
	1724 Taylor Ave. (72-25-14-351-044)	LOT 6	SUPERVISOR'S REPLAT OF ROSZEL & TAYLOR SUB.	1

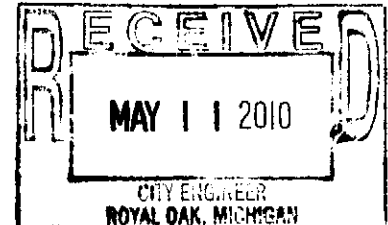

EXHIBIT A

CITY ASSESSOR'S OFFICE

City of Royal Oak

211 Williams Street, P.O. Box 64
Royal Oak, Michigan 48068

(248) 246-3114
Fax (248) 246-3001



June 14, 2010

The Honorable Mayor and
Members of the City Commission

At the Regular Meeting of the City Commission held June 7, 2010, the City Engineer presented a petition for installing the recommended 6" thick concrete paving, 31' wide with integral curb and gutter for N. Edison Avenue from E. University Avenue to the North line of Lot 46. Your Honorable Body referred the petition to the City Assessor for the purpose of preparing the necessary special assessment district. I have determined the revised district to be as follows:

**6" CONCRETE PAVEMENT, 31 FEET WIDE
WITH INTEGRAL CURB AND GUTTER
FOR N. EDISON AVENUE,
FROM E. UNIVERSITY AVENUE TO THE NORTH LOT LINE OF LOT 46**

Total Estimated Cost	\$17,450.00
Total District Portion	\$9,450.00
City at Large Portion	\$8,000.00

The City Commission may now initiate the necessary proceedings toward the adoption of Standard Resolution No. 4.

Respectfully submitted,

Approved,

James M. Geiermann
City Assessor

Donald E. Johnson
City Manager

CC: Donald E. Johnson, City Manager

EXHIBIT B

PAVING

\$13,960.00	Estimated Cost
<u>\$3,490.00</u>	25% Engineering & Inspection
\$17,450.00	Total Cost

\$9,450.00	District Portion
<u>\$8,000.00</u>	City At Large
\$17,450.00	Total Cost

SPECIAL ASSESSMENT PAVING PETITION EVALUATION

PETITION EVALUATED: May 17, 2010

PETITION SUBMITTED: May 11, 2010

SPECIAL ASSESSMENT 31' WIDE, 6" THICK CONCRETE PAVING WITH INTEGRAL CURB & GUTTER OF NORTH EDISON AVENUE FROM EAST UNIVERSITY AVENUE TO THE N. LOT LINE OF LOT 46

NORTH EDISON AVENUE

BENEFIT UNITS	LF OF PETITION SIGNATURES	% IN FAVOR
3	2	66.7 %

BENEFIT UNITS	PROPERTY	PETITION SIGNATURES
1	300 N. EDISON	1
1	301 N. EDISON	1
1	1724 TAYLOR	-
TOTAL: 3 BENEFIT UNITS		2 BENEFIT UNITS

* Side Yard Rates Apply – unadjusted frontage shown in table

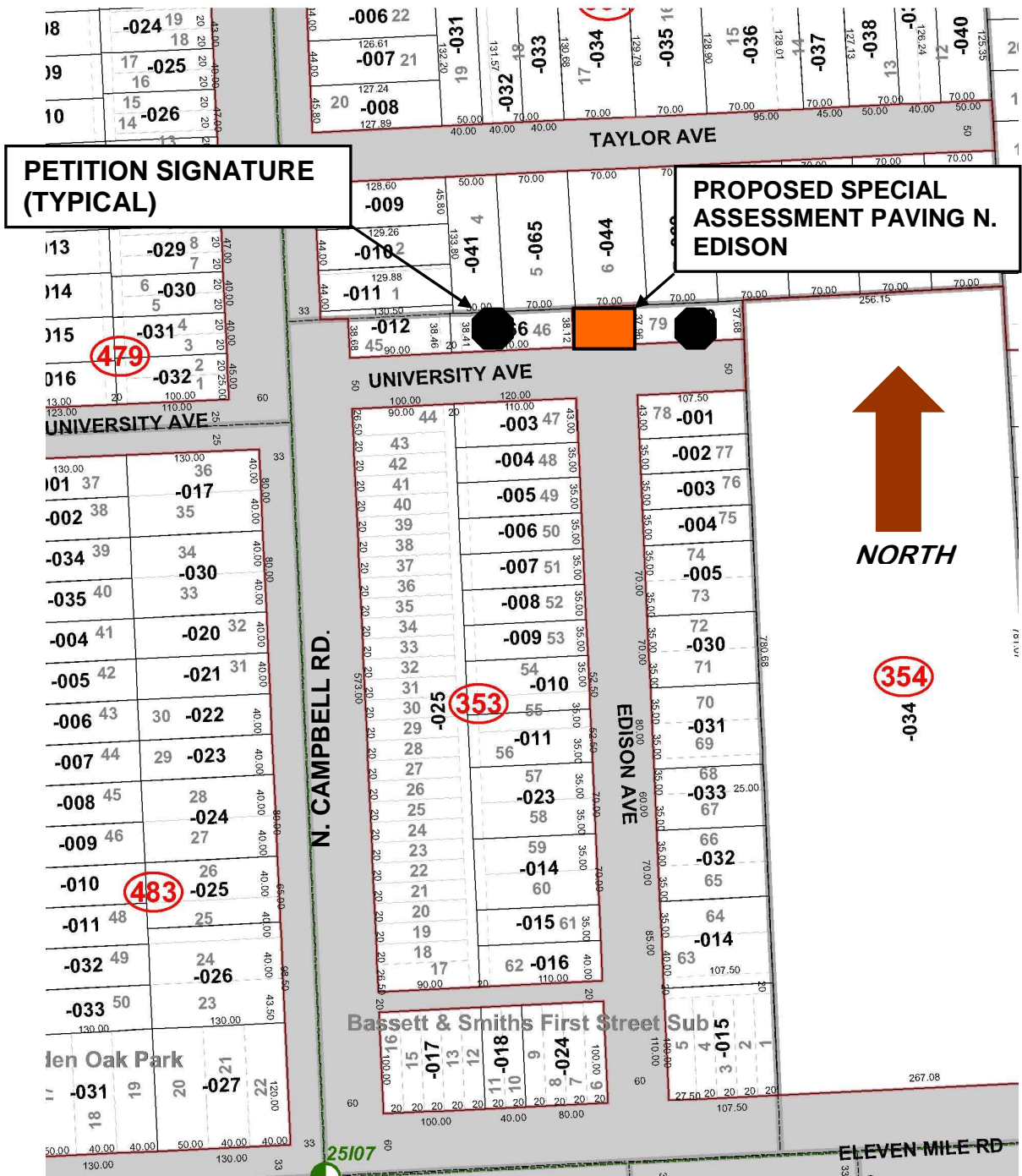

SPECIAL ASSESSMENT 31' WIDE, 6" THICK CONCRETE PAVING WITH INTEGRAL CURB & GUTTER OF NORTH EDISON AVENUE FROM EAST UNIVERSITY AVENUE TO THE N. LOT LINE OF LOT 46

EXHIBIT C